

## **CGR\_ B**

### **Parishes Affected**

Henley-on-Thames and Bix and Assendon

### **Matter to be considered**

Review of parish boundary at Swiss Farm Park Homes currently split between Henley-on-Thames parish and Bix and Assendon parish.

### **Impact on district and county council boundaries**

Henley and Woodcote and Rotherfield district wards  
Henley and Sonning Common county divisions

If the committee agrees the recommendation officers will request the Local Government Boundary Commission for England to make related orders to alter both the district wards and county division boundaries to reflect the changes made at parish level and retain coterminous boundaries.

### **Proposal agreed by the Community Governance and Electoral Issues Committee on 25 May 2022 for consultation**

To consult on a proposal to transfer Swiss Farm Touring and Camping site from Bix and Assendon parish to Henley-on-Thames parish.

### **Summary of responses to the draft proposal consultation**

Henley-on-Thames Town Council supports the proposal.

Bix and Assendon Parish Council did not respond to the consultation.

Three residents directly impacted by the proposal responded to the consultation in support of the proposal.

### **Recommendation**

To transfer Swiss Farm Touring and Camping site from Bix and Assendon parish to Henley-on-Thames parish within the Henley North Ward – as shown below.

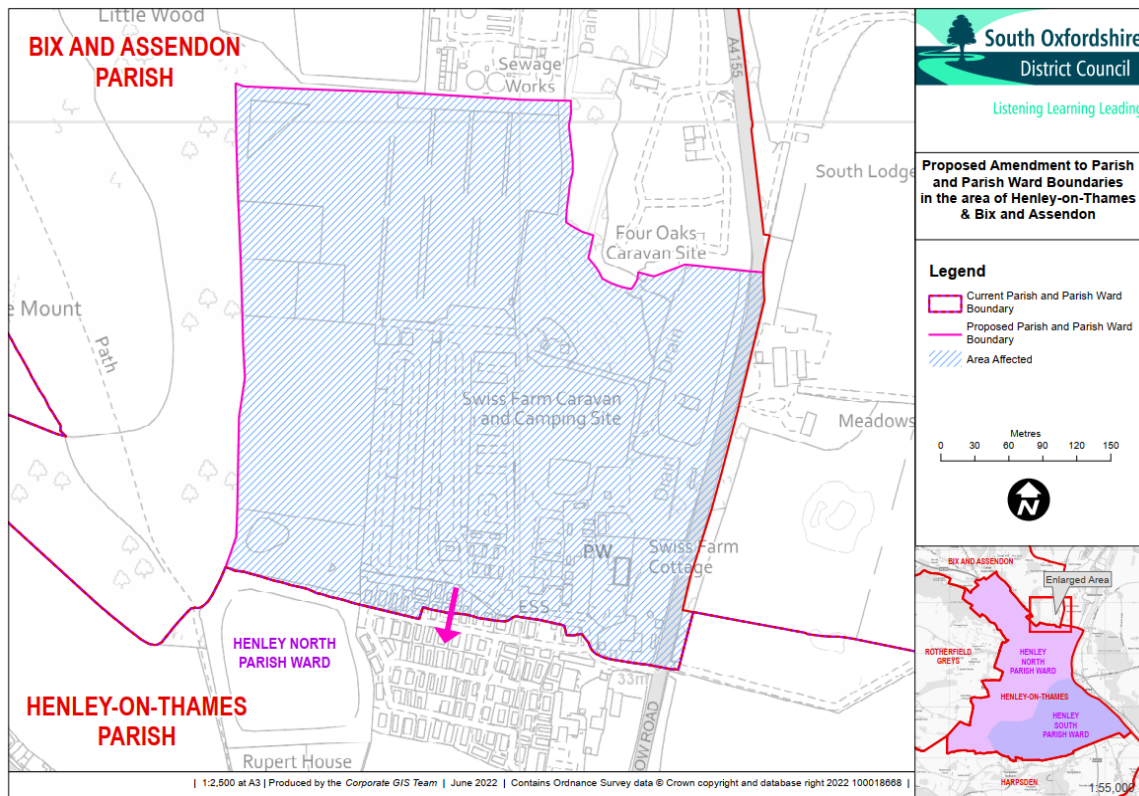

### Justification for final recommendation

The identities and interests of the residents, as well as effective and convenient representation at local government level, are best served by locating the whole of Swiss Farm Touring and Camping site in one parish. The site lies directly adjacent to Henley-on-Thames parish and effectively forms part of it. It therefore seems logical to transfer those properties currently in Bix and Assendon parish into Henley-on-Thames parish. No objections were received with three in support of the proposal.